

**ASSEMBLY**

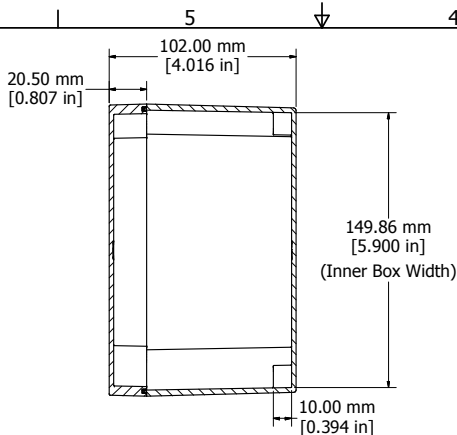

**SECTION A-A**  
End View of Assembly

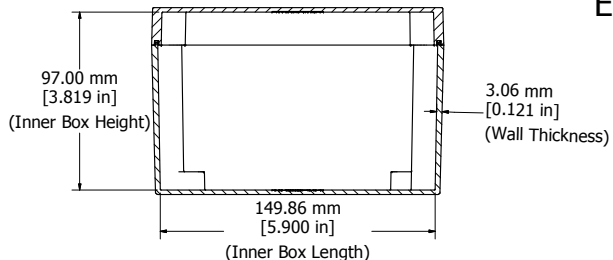

**SECTION R-R**  
Side View of Assembly

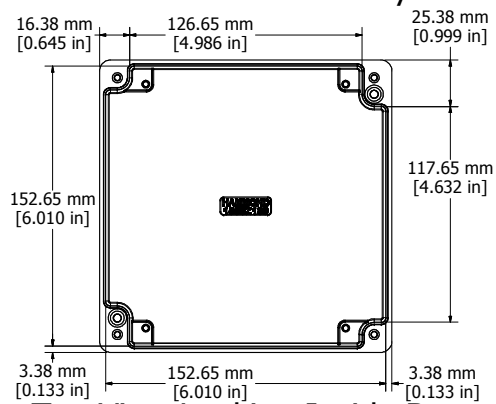

**Top View Looking Inside Box**

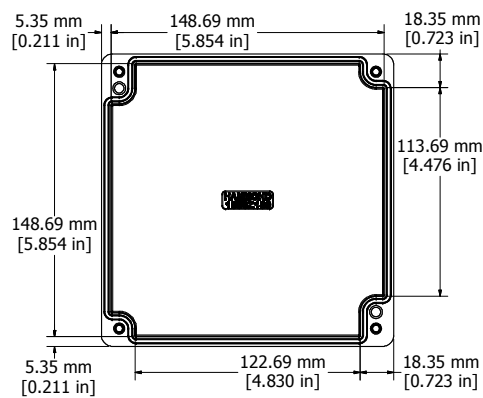

**View Looking Inside Lid**

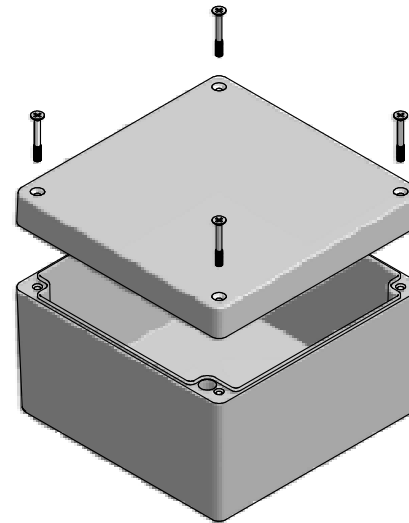

Enclosures can be Factory Modified ( Milling, Drilling, Printing etc. )  
Contact Factory [mjm@hammondmgf.com](mailto:mjm@hammondmgf.com) for quotes  
Solid models of this enclosure available in STEP or IGES.

**NOTES**

Purchased assembly includes enclosure, M4x30 lid screws	
Gasket - Pre-formed Silicone Rubber	
Cover screws should be torqued to 5-7.5 lbf.in (50-75 cN.m)	

**1550Z139**

**PART NUMBERS**

Unfinished	1550Z139
Black Textured Powder Paint - RAL 9011	1550Z139BK



**1550Z139**

[www.hammondmgf.com](http://www.hammondmgf.com)